



MALLINSON
& CO

INNOVATIVE PROPERTY EXPERTS

Ings Way, Penistone, Sheffield, S36 7GL

Offers Over £335,000

🛏️ 4 🚿 3 🚗 2



- DETACHED BUNGALOW
- 3 / 4 BEDROOMS
- 2 RECEPTION ROOMS
- 3 BATHROOMS
- CLOSE TO OPEN COUNTRYSIDE
- STUNNING RURAL SETTING
- IN NEED OF MODERNISATION
- DETACHED DOUBLE GARAGE & 2 DRIVEWAYS
- GARDENS TO 3 ELEVATIONS
- HIGHLY REGARDED LOCATION



TAKE A LOOK AT THIS ... SITUATED IN AN OUTSTANDING VILLAGE LOCATION IS THIS DECEPTIVELY SPACIOUS, THREE / FOUR BEDROOM DETACHED BUNGALOW, SET WITHIN A LARGE CORNER PLOT WITH GARDENS TO THREE ELEVATIONS, A DETACHED DOUBLE GARAGE AND TWO DRIVEWAYS. THE PROPERTY CURRENTLY FEATURES AN ANNEX STYLE BEDROOM FOUR, TWO EN SUITE FACILITIES, IS IN NEED OF SOME MODERNISATION AND OFFERS FURTHER DEVELOPMENT POTENTIAL. THE PROPERTY GIVES EASY ACCESS TO LOCAL AMENITIES, SCHOOLING AND STUNNING OPEN COUNTRYSIDE.

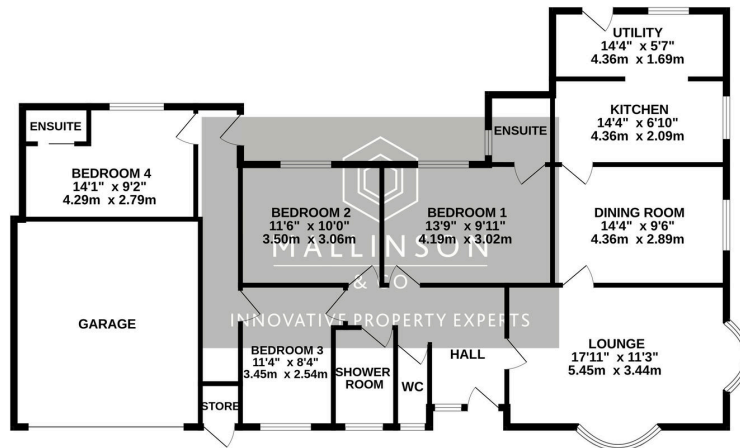

Whilst every attempt has been made to ensure the accuracy of the floorplan contained here, measurements of doors, windows, rooms and any other items are approximate and no responsibility is taken for any error, omission or mis-statement. This plan is for illustrative purposes only and should be used as such by any prospective purchaser. The services, fixtures and appliances shown have not been tested and no guarantee as to their quantity or efficiency can be given. Made with Metreps ©2024

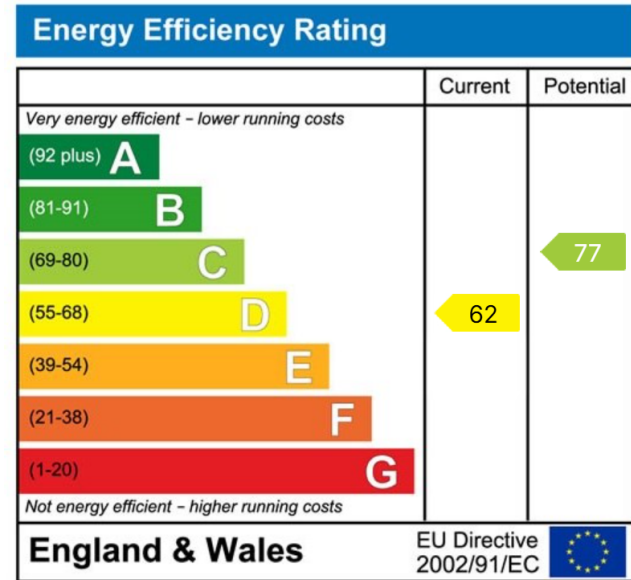

**INNOVATIVE
PROPERTY
EXPERTS**

Mallinson & Co

Office: 01226 414 150

Email: ben@mallinsonandco.co.uk

Web: www.mallinsonandco.co.uk

Suite 2, Penistone 1, St. Mary's Street, Penistone, Sheffield S36 6DT