



MALLINSON
& CO

INNOVATIVE PROPERTY EXPERTS

Barnside Close, Penistone, Sheffield, S36 6UB

£350,000

🛏 3 🚿 2 🛋 2



- DETACHED
- 3 BEDROOMS
- SINGLE STOREY EXTENSION
- OPEN PLAN LIVING KITCHEN
- BEAUTIFUL FIXTURE & FINISH THROUGHOUT
- 4 PIECE BATHROOM SUITE
- WESTERLEY FACING LANDSCAPED GARDEN
- CUL DE SAC LOCATION
- WITHIN WALKING DISTANCE OF PENISTONE & OPEN COUNTRYSIDE
- EASY ACCESS TO AMENITIES, SCHOOLS AND TRANSPORT LINKS



TAKE A LOOK AT THIS ... LOCATED ON THE HIGHLY REGARDED BARNSIDE CLOSE IS THIS BEAUTIFULLY PRESENTED, THREE BEDROOM, SINGLE STOREY EXTENDED DETACHED PROPERTY, FEATURING A LANDSCAPED WESTERLY FACING GARDEN AND SUPERB OPEN PLAN LIVING KITCHEN WITH A HIGH QUALITY FIXTURE AND FINISH. THE PROPERTY IS IDEALLY SUITED TO A COUPLE, FAMILY OR POTENTIAL DOWNSIZER AND AN EARLY INSPECTION IS HIGHLY RECOMMENDED.

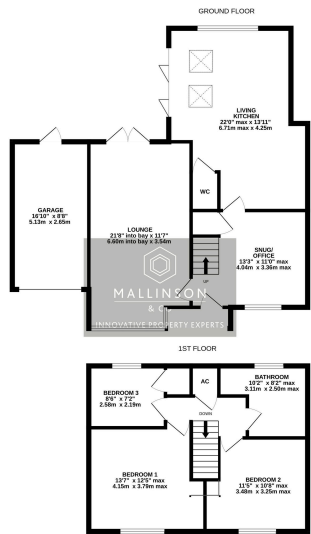

Where every effort has been made to ensure the accuracy of the floor plan contained here, measurements of rooms, walls, floors and any other items are approximate and do not constitute a guarantee for any time, occasion or in any particular. They are for general guidance only and should be used as a guide only for the purchaser's attention. The purchaser should verify the measurements and dimensions of the property as to their own satisfaction and reference can be given to the relevant legislation.

Score	Energy rating	Current	Potential
92+	A		
81-91	B		83 B
69-80	C		
55-68	D	67 D	
39-54	E		
21-38	F		
1-20	G		



**INNOVATIVE
PROPERTY
EXPERTS**

Mallinson & Co

Office: 01226 414 150
 Email: ben@mallinsonandco.co.uk
 Web: www.mallinsonandco.co.uk
 Suite 2, Penistone 1, St. Mary's Street, Penistone, Sheffield S36 6DT